

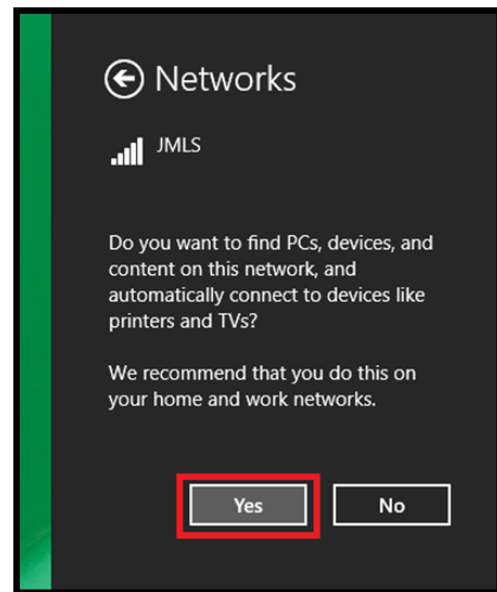

Connect to JMLS Wi-Fi: Windows 8 and 10

1. Click the Wi-Fi icon on your laptop. Select the network called **JMLS**. The network password/security key is **PracticeReady** (all one word, capital P and R). Click **Next**.
2. If you're asked if you'd like to connect to devices automatically, click **Yes**.

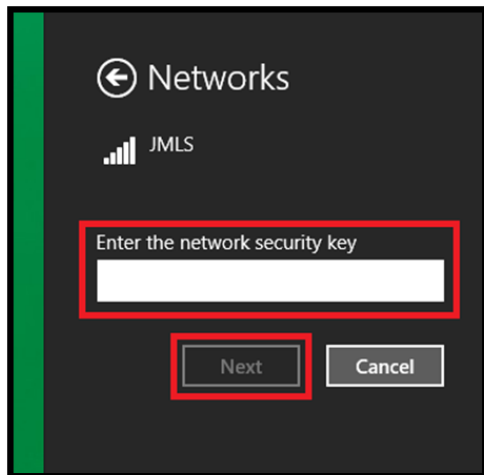

3. Open a web browser. It should automatically redirect to a User Registration page. If it doesn't, type captive01.jmls.com directly into the address bar. When the page loads, click **Accept**.

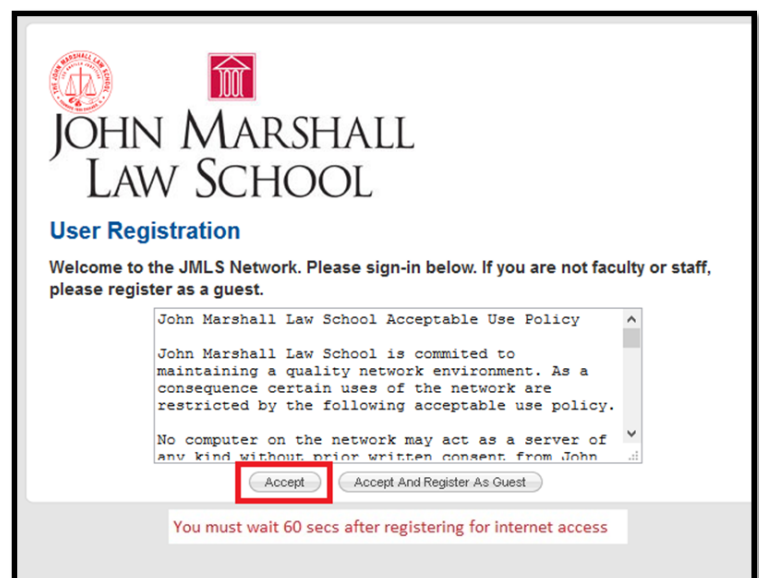

4. On the next screen, enter your **JMLS username and password**, then click **Register**.

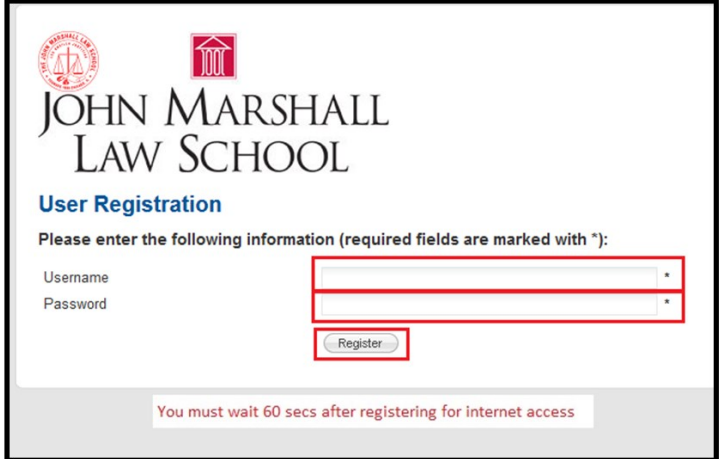

5. If the web browser asks if you want to remember the password, select **Remember Password**.

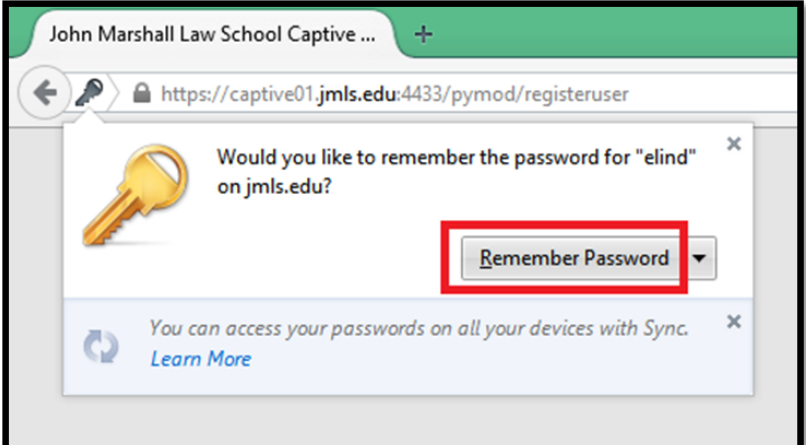

6. When the screen says Registration is Complete, please **wait 30–60 seconds then reopen your browser**. You should now be connected to the network.

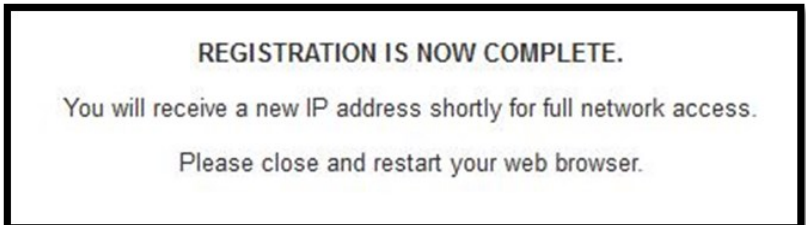

Questions?

For additional help, please contact the **ITS Help Desk** via the Help Desk Portal at helpdesk.jmls.edu, by phone at 312.427.2737 x550, or by email at helpdesk@jmls.edu. You can also visit us in Room 733, 7th floor (via the main State St building elevators or stairs from the 6th floor just outside the library).